

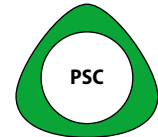

**Garant** Tool arbors with polygonal shank (PSC) – ISO 26623-1



- With Balluffchip bore.
  - All shanks hard turned (for smooth running!).
  - Mating faces of the PSC internal contour machined.
- Optional extras:** Coolant pipe and plug-in socket No. 309885 / 9893.

**Shrink-fit chucks 4° 30'**

G 2.5 25000 min <sup>-1</sup>	HSC	HPC
-------------------------------------	-----	-----

**Application:** For clamping tools with shank tolerance h6.  
**Optional extras:** Shrink-fit chuck extensions No. 302410 – 302417. Shrink-fit units No. 354210 – 354450.

**Note:**  
 30 8568 Size 3–5 – No length adjustment available.



30 8568

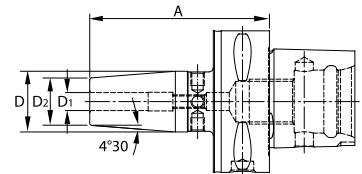

Clamping range Ø D <sub>1</sub>		mm	3	4	5	6	8	10	12	14	16	18	20	25	32
31C	<b>30 8566</b>	PSC 40 short	–	–	–	412.04	412.04	412.04	412.04	412.04	412.04	412.04	412.04	–	–
31C	<b>30 8567</b>	PSC 50 short	–	–	–	415.44	415.44	415.44	415.44	415.44	415.44	415.44	415.44	–	–
31C	<b>30 8568</b>	PSC 63 short	488.35	488.35	488.35	396.79	396.79	396.79	396.79	396.79	396.79	396.79	396.79	396.79	396.79
31C	<b>30 8571</b>	PSC 63 A = 120	–	–	–	523.95	523.95	523.95	523.95	523.95	523.95	523.95	523.95	–	–
31C	<b>30 8573</b>	PSC 63 short	–	–	–	479.87	479.87	479.87	479.87	–	479.87	–	479.87	–	–
31C	<b>30 8574</b>	PSC 63 A = 120	–	–	–	598.57	598.57	598.57	598.57	–	598.57	–	598.57	–	–
31C	<b>30 8575</b>	PSC 80 short	–	–	–	661.31	661.31	661.31	661.31	661.31	661.31	661.31	661.31	661.31	661.31
Dimension A (30 8566, 30 8567)		mm	–	–	–	75	75	75	75	80	80	80	85	90	–
Dimension A (30 8568, 30 8573, 30 8575)		mm	80	80	80	80	80	80	80	85	85	85	85	90	95
Ø D		mm	17	17	17	27	27	32	32	34	34	42	42	53	53
Ø D <sub>2</sub>		mm	12	12	12	21	21	24	24	27	27	33	33	44	44

**Precision short drill chucks with polygonal shank (PSC)**

G 2.5 18000 min <sup>-1</sup>	↻	≤14 Nm
-------------------------------------	---	--------

- For clockwise and anticlockwise rotation.
- Sand-blasted.

**Supplied with:**  
 30 8587 – **Clamping wrench.**  
 30 8595 – **Torx® clamping wrench.**



30 8595

Clamping range		mm	0,3-10	1-16
31B	<b>30 8587</b>	PSC 40	607.05	–
31B	<b>30 8595</b>	PSC 63	–	785.09
Dimension A		mm	74	93.1
Ø D		mm	36	50
Spare Torx® screwdriver 625220			–	TX25
Spare hexagon screwdriver 627425			4 AF	–

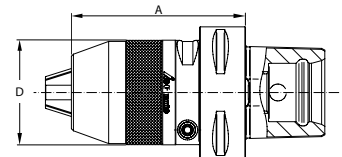

**Wrench for pull studs**

Single-piece wrench.  
**Advantage:** Unlike conventional clamping wrenches it cannot slip, no risk of injury!  
**Application:** For safe tightening of pull studs.  
**Note:** See pages 861–862 for suitable pull studs.



30 8820



30 8825

suitable for steep tapers		SK	30	40	50
37D	<b>30 8820</b>	Pull stud wrench for Pull studs to DIN 69872	–	52.03	57.99
31Z	<b>30 8825</b>	Pull stud wrench for Pull studs to ISO 7388	–	49.47	55.00
37D	<b>30 8830</b>	Pull stud wrench for Pull studs to ISO 7388	–	52.03	57.99
31Z	<b>30 8835</b>	Pull stud wrench for Pull studs to ISO 7388	41.04	49.47	–
Width across flats AF (30 8820, 30 8825)		mm	–	19	30
Width across flats AF (30 8830, 30 8835)		mm	13	18	30

## Pull studs (PS) for tool arbors – accessories







- Application:**
- For tools with taper shanks see also **DIN 69871 and JIS B 6339** (MAS-BT).
  - In machining centres (machines **with** automatic tool changers).
  - In NC machines (machines **without** automatic tool changers).

**Note:** Look in the eShop - you will find the right clamping wrench for every job.

### Pull studs

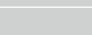
DIN  
69872

suitable for steep tapers

				30	40	50
31Z	<b>30 8600</b>	 Pull stud <b>Form A</b>	<b>with bore</b>	–	12.44	15.89
31Z	<b>30 8605</b>	 Pull stud, 18CrNiMo7 <b>Form A</b>	<b>with bore</b>	–	14.57	18.10
32Z	<b>30 8610</b>	 Pull stud <b>stud sealed, form A</b>	<b>with bore</b>	11.33	10.99	15.27
31Z	<b>30 8615</b>	 Pull stud, 18CrNiMo7 <b>sealed, form B</b>	<b>without bore</b>	–	15.54	18.93
31Z	<b>30 8620</b>	 Pull stud <b>sealed, form B</b>	<b>without bore</b>	–	13.55	16.58
32Z	<b>30 8625</b>	 Pull stud <b>Mori-Seiki, sealed,</b>	<b>with bore Ø 7 mm</b>	–	13.06	–
32Z	<b>30 8630</b>	 Pull stud <b>form A</b>	<b>with bore Ø 7 mm</b>	–	13.61	–
Ø D		mm		17	23	36
Ø D <sub>1</sub>		mm		13	19	28
L		mm		44	54	74
L <sub>1</sub> (30 8600, 30 8605, 30 8610, 30 8615, 30 8620, 30 8625)		mm		24	26	34
L <sub>1</sub> (30 8630)		mm		–	29	–
M				M12	M16	M24
Angle A (30 8625, 30 8630)		degrees		–	15	–
maximum tightening torque		N-m		20	50	150
suitable for taper arbors with colour code						



30 8600 / 8605



30 8610



30 8615 / 8620

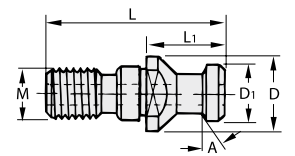

#### Suitable for:



30 8635 – FADAL, similar to ISO 7388, 3 mm, extended.

				40
32Z	<b>30 8635</b>	 Pull stud <b>sealed</b>	<b>with bore</b>	13.89
Ø D		mm		22
Ø D <sub>1</sub>		mm		18.95
L		mm		47.5
L <sub>1</sub>		mm		19.25
M				M16
maximum tightening torque		N-m		50
suitable for taper arbors with colour code				

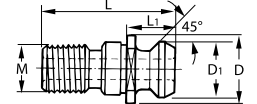

30 8635



				40	50
31Z	<b>30 8640</b>	 Pull stud <b>Form B</b>	<b>with bore</b>	12.44	15.89
32Z	<b>30 8650</b>	 Pull stud <b>sealed, form B</b>	<b>with bore</b>	11.06	15.27
31Z	<b>30 8660</b>	 Pull stud <b>sealed</b>	<b>without bore</b>	13.55	16.58
Ø D		mm		22.5	36
Ø D <sub>1</sub>		mm		18.95	29.1
L		mm		44.5	65.5
L <sub>1</sub>		mm		16.25	25.55
M				M16	M24
maximum tightening torque		N-m		50	150
suitable for taper arbors with colour code					

ISO  
7388



30 8640



30 8650

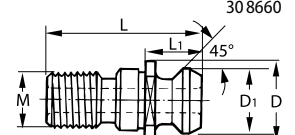

### Pull studs - Mazak (with end face ground flat)

CAT

- End face turned flat.

				40M	40M7
32Z	<b>30 8670</b>	 Pull stud <b>Mazak sealed, form A</b>	<b>with bore</b>	12.51	13.82
Ø D		mm		21.8	
Ø D <sub>1</sub>		mm		18.79	
L		mm		41.25	
L <sub>1</sub>		mm		16.25	
M				M16	
maximum tightening torque		N-m		50	
suitable for taper arbors with colour code					
Bore Ø		mm		6	7



30 8670

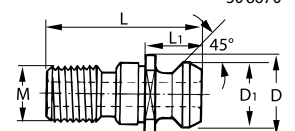

**Colour code:**     SK 30     SK 40     SK 50

